

- NOTES:
1. MATERIALS: "G" STYLE
- 1.1 SHELL, FERRULE  
BRASS PER QQ-B-626  
FINISH: GOLD, OVER  
ELECTROLESS NICKEL  
PER MIL-G-45204, TYP 2, CLASS 1
- 1.2 INSERT  
PEEK, GLASS FILLED PER  
MIL-P-46183
- 1.3 CONTACTS  
COPPER ALLOY  
FINISH: GOLD PER MIL-G-45204
- 1.4 GASKETS  
SILICONE RUBBER PER AMS 3304
- 1.5 ALTERNATE SHELL MATERIALS  
AND FINISHES:
- "M" STYLE: BRASS, WITH  
ELECTROLESS NICKEL FINISH  
PER AMS-C-26074, CLASS 4, GRADE B
- "A" STYLE: BRASS, WITH GOLD PLATE,  
BLACK CHROMATE
- "K" STYLE: STAINLESS STEEL,  
300 SERIES, WITH PASSIVATION

REVISION HISTORY		
REVISION	DATE	COMMENT
0	02 /10 / 17	INITIAL RELEASE

M4,5 X 0,35 THREAD

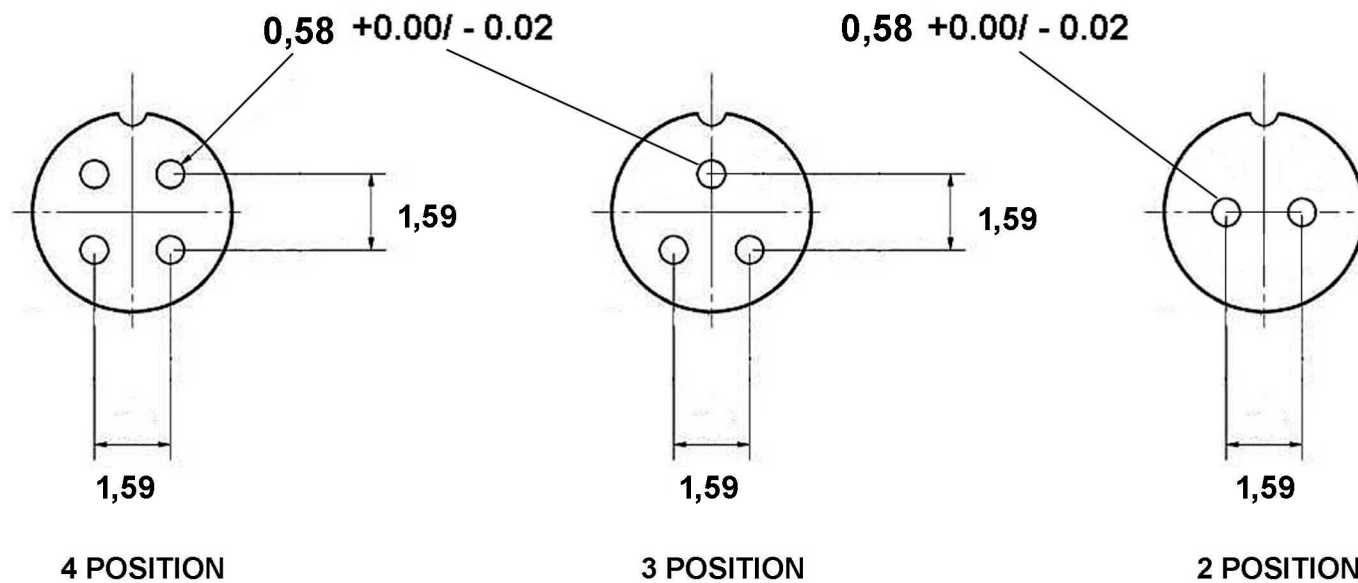
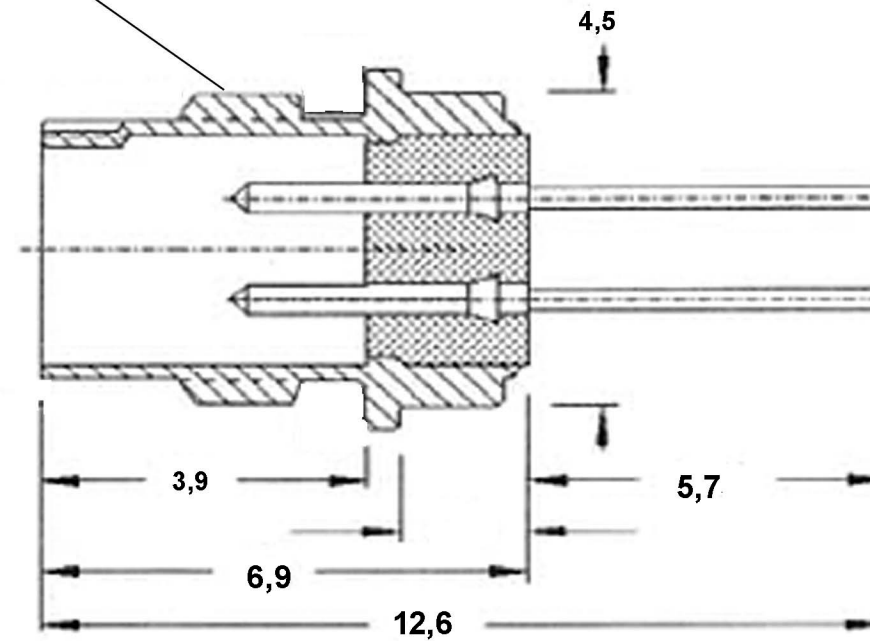

UNLESS OTHERWISE NOTED:  
DIMENSIONS ARE IN MILLIMETERS  
DO NOT SCALE THIS DRAWING

.X DECIMALS ARE  $\pm 0.5$   
.XX DECIMALS ARE  $\pm 0.25$   
.XXX DECIMALS ARE  $\pm 0.13$

ANGLES ARE  $\pm 0.5^\circ$

DRAWING

SC

MILSPECWEST - MICRO PRODUCTS  
CAGE CODE: 3HD49

CHECKED

TS

DESCRIPTION:  
ULTRA MICRO PCB MOUNT  
RECEPTACLE

Q.A.

KB

DWG. NO.  
MSWU-\* -C-\*\*\*

REVISION: 0

SHEET 1 OF 2

THIS DOCUMENT IS SOLE PROPERTY OF MILSPECWEST AND IS ISSUED IN STRICT CONFIDENCE THAT IT WILL NOT BE REPRODUCED IN ANY WAY OR USED TO SOLICIT BUSINESS OF A COMPETITIVE NATURE. DISTRIBUTION OF THIS DOCUMENT IS PROHIBITED UNLESS WRITTEN CONSENT IS OBTAINED FROM MILSPECWEST. THIS DOCUMENT IS SUITABLE FOR ENGINEERING EVALUATION AND MAY BE USED IN TECHNICAL SPECIFICATIONS.

	1	2	3	4	5	6	7	8			
A	<div>NOTES:</div> <div>1. MATERIALS: "G" STYLE</div> <div>1.1 SHELL, FERRULE</div> <div>BRASS PER QQ-B-626</div> <div>FINISH: GOLD, OVER</div> <div>ELECTROLESS NICKEL</div> <div>PER MIL-G-45204, TYP 2, CLASS 1</div> <div>1.2 INSERT</div> <div>PEEK, GLASS FILLED PER</div> <div>MIL-P-46183</div> <div>1.3 CONTACTS</div> <div>COPPER ALLOY</div> <div>FINISH: GOLD PER MIL-G-45204</div> <div>1.4 GASKETS</div> <div>SILICONE RUBBER PER AMS 3304</div> <div>1.5 ALTERNATE SHELL MATERIALS</div> <div>AND FINISHES:</div> <div>"M" STYLE: BRASS, WITH</div> <div>ELECTROLESS NICKEL FINISH</div> <div>PER AMS-C-26074, CLASS 4, GRADE B</div> <div>"A" STYLE: BRASS, WITH GOLD PLATE,</div> <div>BLACK CHROMATE</div> <div>"K" STYLE: STAINLESS STEEL,</div> <div>300 SERIES, WITH PASSIVATION</div>					REVISION HISTORY			A		
						REVISION	DATE	COMMENT			
						0	02/17/2017				
B	<div>SPECIFICATIONS:</div> <div></div> <div>ELECTRICAL:</div> <div></div> <div>ELECTRICAL RESISTANCE:</div> <div>10,000 M OHMS PER MIL-C-22557</div> <div>RATED WORKING VOLTAGE:</div> <div>400V @ SEA LEVEL</div> <div>DIELECTRICWITHSTANDING:</div> <div>1,000 V @ SEA LEVEL PER MIL-C-22557</div> <div>CONTACT VOLTAGE DROP:</div> <div>4 mV @ 1 AMP PER MIL-C-22557</div> <div>CONTACT RESISTANCE:</div> <div>4 MOHM @ 1 AMP PER MIL-C-22557</div> <div>CONTACT CURRENT RATING:</div> <div>3 AMP</div>								B		
C	<div>ENVIRONMENTAL:</div> <div></div> <div>VIBRATION:</div> <div>MIL STD 202A METHOD 204 TEST COND B( 15G's)</div> <div>NO DISCONTINUITY IN EXCESS OF 1 MICROSECOND</div> <div>SHOCK:</div> <div>MIL STD 202 METHOD 202, 300 G's NO EVIDENCE OF DAMAGE</div> <div>TEMPERATURE CYCLING:</div> <div>MIL STD 202 METHOD 102, CONDITION C</div> <div>CORROSION ( SALT SPRAY):</div> <div>MIL STD 202 METHOD 10,COND B 5% SALT SOLUTION</div> <div>MOISTURE RESISTANCE:</div> <div>MIL STD 202C METHOD 106B, OMITTING STEO 7B</div> <div>AND HIGH HUMIDITY TESTS</div>								C		
D	<div>PART NUMBER BREAKDOWN</div> <div>MSWU - G - C - 04 P</div> <div></div> <div>P = PIN</div> <div>S = SOCKET</div> <div>NUMBER OF CONTACTS</div> <div>02</div> <div>03</div> <div>04</div> <div>SHELL SIZE (SEE TABLE 2)</div> <div>BODY STYLE</div> <div>B = PLUG</div> <div>R = IN LINE RECEPTACLE</div> <div>C = STRAIGHT PCB MOUNT</div> <div>D = FRONT PANEL JAM NUT MOUNT</div> <div>E = FRONT PANEL SOLDER MOUNT</div> <div>F = RIGHT ANGLE PCB MOUNT</div> <div>FINISH AND MATERIAL</div> <div>G = BRASS WITH GOLD OVER ELEC NICKEL</div> <div>M = BRASS WITH ELECTROLESS NICKEL</div> <div>A = BRASS WITH BLACK ANODIZE</div> <div>K = STAINLESS STEEL WITH PASSIVATION</div> <div>BASIC PART NUMBER</div>								D		
E	<div>THIS DOCUMENT IS SOLE PROPERTY OF MILSPECWEST AND IS ISSUED IN STRICT CONFIDENCE THAT IT WILL NOT BE REPRODUCED IN ANY WAY OR USED TO SOLICIT BUSINESS OF A COMPETITIVE NATURE. DISTRIBUTION OF THIS DOCUMENT IS PROHIBITED UNLESS WRITTEN CONSENT IS OBTAINED FROM MILSPECWEST. THIS DOCUMENT IS SUITABLE FOR ENGINEERING EVALUATION AND MAY BE USED IN TECHNICAL SPECIFICATIONS.</div>								E		
F	<div>UNLESS OTHERWISE NOTED:</div> <div>DIMENSIONS ARE IN MILLIMETERS</div> <div>DO NOT SCALE THIS DRAWING</div> <div></div> <div>.X DECIMALS ARE ±0.5</div> <div>.XX DECIMALS ARE ±0.25</div> <div>.XXX DECIMALS ARE ±0.13</div> <div>ANGLES ARE ±0.5°</div>					DRAWING	SC	MILSPECWEST - MICRO PRODUCTS		F	
						CHECKED	TS	DESCRIPTION:			
						Q.A.	KB	DWG. NO.	REVISION: 0		
				MSWU-* -C-***		SHEET 2 OF 2					
	1	2	3	4	5	6	7	8			