

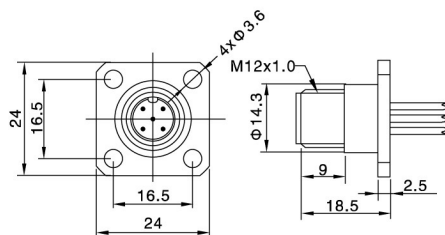

## M12 Male Panel Mount, Solder, with Flange

- Connector series: M12
- Gender: Male
- Coding: A,B,C,D
- Locking type: Fix screw
- Mounting type: Flange
- Part No.: MB12MS\*FLF\*\*ST

\* refers to coding type  
\*\* refers to pins number



### General information



Standard: IEC 61076-2-101

Ambient temperature: -20°C ~ +80°C

Connector insert: TPU

Connector contacts: Brass with gold plated

Connector nut/screw: Brass with nickel plated

Seal / O-ring: Epoxy resin / FKM

Insulation resistance:  $\geq 100M\Omega$

Contact resistance :  $\leq 5m\Omega$

Shielding: Unavailable

IP rating: IP68 in locked condition

Mating endurance: >500 cycles

### Electrical data & Mechanical data

Contacts	Available Coding				Contacts termination	Rated current	Voltage		Wire gauge / size		Part No.
	A	B	C	D			A/C	D/C	AWG	mm <sup>2</sup>	
03 pins					Solder version	4A	250V	250V	22AWG	0.34	MB12MSAFLF03ST MB12MSBFLF03ST MB12MSCFLF03ST
04 pins					Solder version	4A	250V	250V	22AWG	0.34	MB12MSAFLF04ST MB12MSBFLF04ST MB12MSCFLF04ST MB12MSDFLF04ST
05 pins					Solder version	4A 2A (C-code)	60V	60V	22AWG 24AWG (C-code)	0.34 0.25 (C-code)	MB12MSAFLF05ST MB12MSBFLF05ST MB12MSCFLF05ST
06 pins					Solder version	2A	30V	30V	24AWG	0.25	MB12MSCFLF06ST
08 pins					Solder version	2A	30V	30V	24AWG	0.25	MB12MSAFLF08ST
12 pins					Solder version	1.5A	30V	30V	26AWG	0.14	MB12MSAFLF12ST
17 pins					Solder version	1.5A	30V	30V	26AWG	0.14	MB12MSAFLF17ST

### Remarks

- Please refer to Page 578 for the Conversion between American Wire Gauge AWG and Wire Cross-section mm<sup>2</sup>.
- Please refer to Page 96 for products' part number encoding rule.